

Gear rings, pressed on

for crane wheels with anti friction bearings acc. to DIN 15 079 with wheel- \varnothing $d_1 \leq 500$ mm
self aligning roller bearings series 222

DIN 15 082

part 2

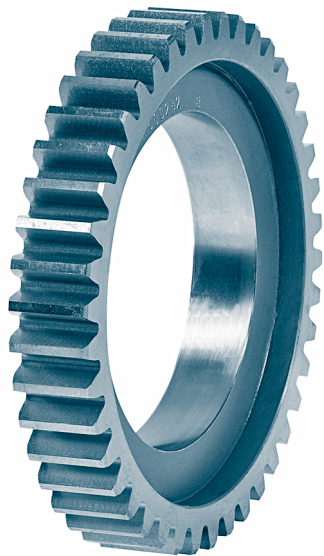

Form K small gear ring (Photo 1)

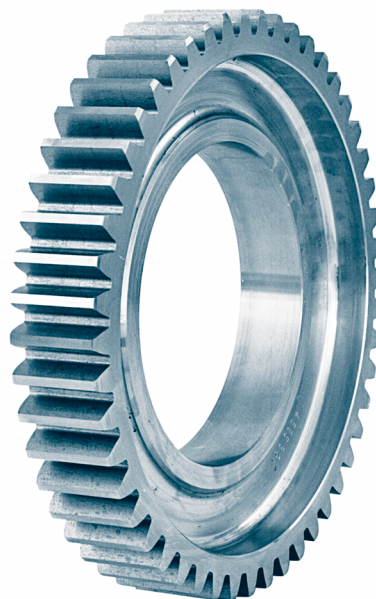

Form G large gear ring (Photo 2)

Designation of a gear ring for wheel- \varnothing $d_1 = 500$ mm, large gear ring form G:

Gear ring G 500.2 DIN 15 082

Form K small gear ring

Form G large gear ring

Material: GE300 (GS-60) or
G42CrMo4+QT

Other material and dimensions (e.g. wheels with self aligning roller bearings series 223) on request.

Gear rings for wheels with self-aligning roller bearings of wheel- \varnothing ≥ 630 mm see DIN 15 082 part 1.

Gear rings, pressed on

for crane wheels with anti friction bearings acc. to DIN 15 079 with wheel- $\varnothing d1 \leq 500$ mm
Rolling bearings series 222

DIN 15082

Teil 2

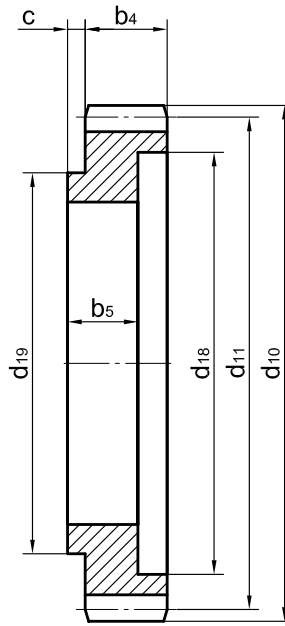
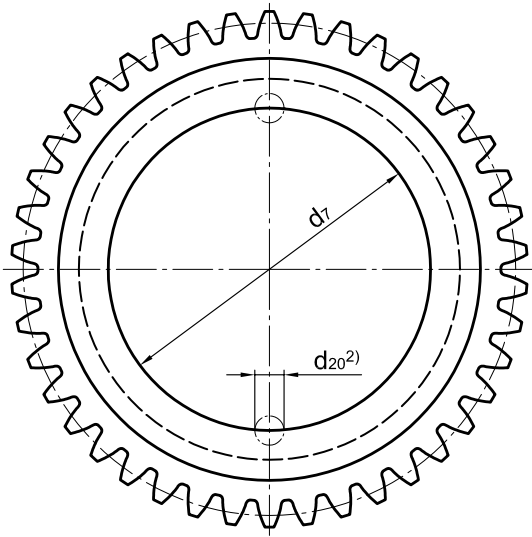

drawing 1

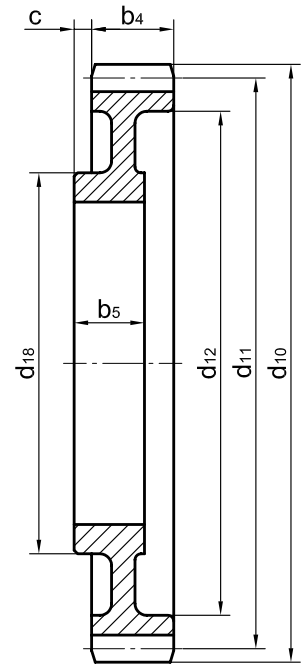

drawing 2

wheel- \varnothing d1	draw- ing	form	no. of teeth ¹⁾	mo- dule	b4	b5	c	d7 H7	d10 h11	d11	d12	d18	d19	d20 ¹⁾	for bearings DIN 635-2	unit weight ≈[kg]
315	1	G	52	6	60	45	10	210	324	312	-	270	240	16	22218	18
400	1	K	40	8	65	55	15	230	336	320	-	276	280	16	22220	20
	2	G	50						416	400	350	270	-			32
500	1	K	42	10	70	60	15	275	440	420	-	360	325	25	22224	40
	2	G	49						510	490	430	325	-			52

1) Tooth form according to DIN 867 without appending modification, pressure angle 20 Degree.

2) Shear joint with heavy duty clamping sleeve acc. to DIN EN ISO 8752 (DIN 1481), gear ring drilled together with crane wheel