

Bandages, machined

for crane wheels as per DIN

DIN 15 083



Bandage with flanges

Designation of a bandage form B with nominal- \emptyset
d1 = 630 mm, gauge b1 = 100 mm:

Bandages B 630 × 100 DIN 15 083

Form S narrow bandages

Form B broad bandages

This standard refers to bandages with running surface profiles
acc. to DIN 15072 for crane wheels with bandages acc. to DIN.

Material: C 60 or
42CrMo4+QT (42CrMo4V) or
34CrNiMo6+QT (34CrNiMo6 V) or
50CrMo4+QT (50CrMo4V)

Other material and dimensions on request.

Bandages, machined

for crane wheels as per DIN

DIN 15 083

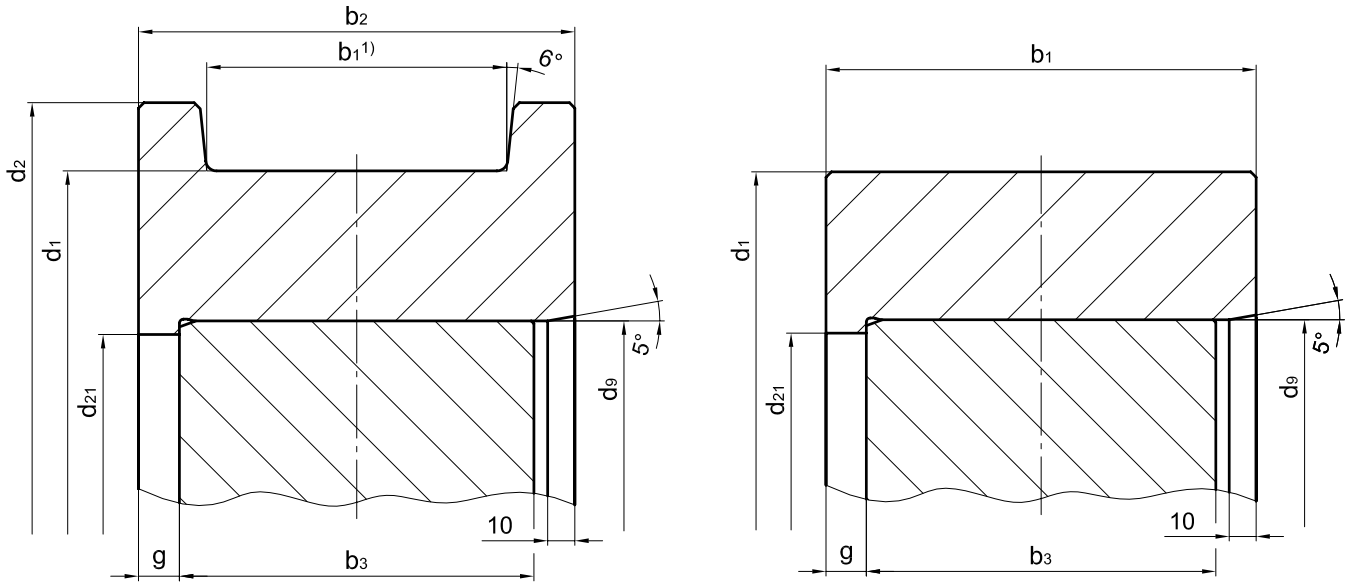

Bandage with flange

Bandages without flange

form	d1	b1 ¹⁾	b2	b3	d2	d9 ²⁾		d21	g	unit weight ³⁾ ≈ [kg]		
						bandage	wheel body			with flange	without flange	
S	400	55-65	110	80	440	310	+0,1 0	+0,6 +0,5	300	15	55	45
B		70-90	140	110							70	55
S	500	55-65	110	80	540	400	+0,1 0	+0,7 +0,6	390	15	75	60
B		70-90	140	110							95	80
S	630	65-75	120	90	680	520	+0,2 0	+1,0 +0,8	510	15	115	95
B		80-110	160	130							150	125
S	710	75-90	140	100	760	590	+0,2 0	+1,1 +0,9	580	20	160	135
B		95-160	210	170							230	205
S	800	75-90	140	100	850	670	+0,2 0	+1,2 +1,0	660	20	190	-
B		95-160	210	170							280	250
S	900	75-90	140	100	950	760	+0,2 0	+1,4 +1,2	750	20	230	-
B		95-160	210	170							345	300
S	1000	75-90	140	100	1050	850	+0,2 0	+1,5 +1,3	840	20	265	-
B		95-160	210	170							400	350
B	1120	95-160	220	180	1180	960	+0,2 0	+1,7 +1,5	950	20	500	-
B	1250	95-160	220	180	1310	1090	+0,2 0	+1,9 +1,7	1080	20	580	-

1) The dimension of the gauge recess b1 to be stated with order. For running surface profiles and correspondence of crane rails to running wheel diameter see DIN 15072

2) Heating temperature of the bandages 250 - 300 °C at 20 °C room temperature. The leading clearance in 40-50 % of the expansion at a heating of the bandage at 230-280 °C.

3) weight refers to max. b1.